

# Venue Floorplan

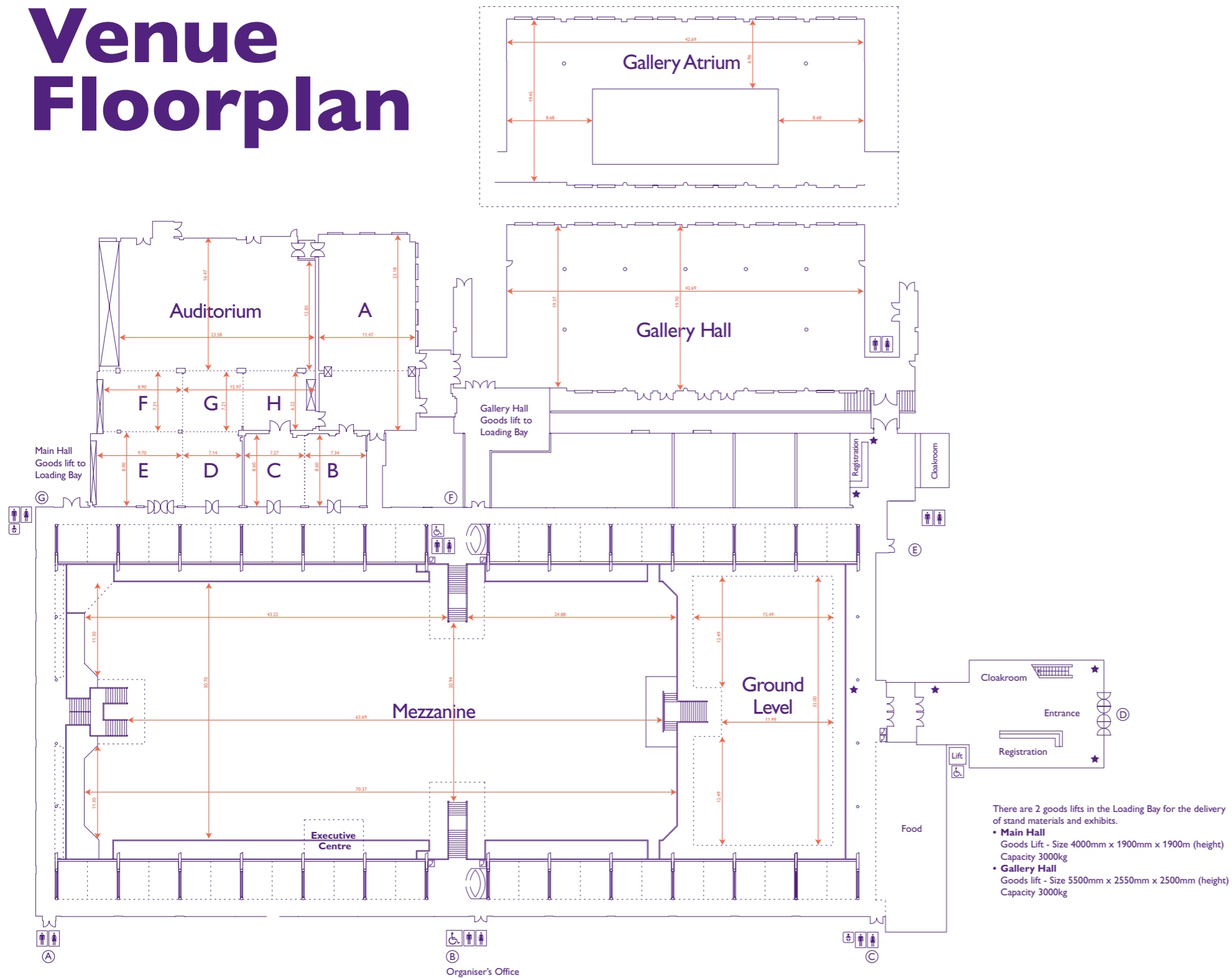

## Dimensions

	Gross Space	Net Space	Length (M)	Width (M)	Height (M)
Mezzanine	2088m <sup>2</sup>	1338 m <sup>2</sup>	70.37	30.70	16.5
Ground Level	471.5m <sup>2</sup>	352.5m <sup>2</sup>	15.49	32.0	-
Gallery Bays	1468m <sup>2</sup>	1010m <sup>2</sup>	7.02	4.67	3.0
Gallery Hall	837m <sup>2</sup>	507m <sup>2</sup>	42.69	19.37	6.85
Gallery Atrium	558m <sup>2</sup>	363m <sup>2</sup>	42.69	19.75	2.75
Conference Centre	1140m <sup>2</sup>	840m <sup>2</sup>			
<b>Total</b>	<b>6565.5m<sup>2</sup></b>	<b>4430.5m<sup>2</sup></b>			

## Notes:

---



---



---



---



---



---

## Mezzanine and Ground

- Fully DDA Compliant
- Fully carpeted exhibition and conference halls
- In house floor plan design service
- Manned service desk during build up and breakdown
- Access for goods direct to hall
- Hall heating and general lighting
- Secure exhibitor storage area available throughout tenancy
- Complimentary Cleaning Services to venue areas
- Digital Directional Signage
- Organiser Car Parking for event duration
- Free WiFi Open Zone (Higher bandwidth upgrade available)

## Registration Desk in the foyer containing

- Wired Internet Connection
- Dedicated phone line
- Power sockets
- Purpose built cloakroom facilities
- Digital signage screens

## Organiser's office space containing

- Reception Area
- Private Office
- Personal Kitchen
- Photocopier
- Phones
- Fax Machine
- Internet/Phone Lines
- Sky Television
- Tannoy to main hall for announcements

## ★ Digital signage locations

- Graphics to be provided by organiser (1080W x 1920L)
- Acceptable formats: VIDEO (MPEG, AVI, Divx, Xvid, VOB), AUDIO (MP3, WMA), JPEG.
- For PowerPoint templates contact your venue manager
- All graphics to be provided not later than 24 hours prior to event for approval by venue

## Ⓐ Stairwells

There are 2 goods lifts in the Loading Bay for the delivery of stand materials and exhibits.

### Main Hall

- Goods Lift - Size 4000mm x 1900mm x 1900m (height)
- Capacity 3000kg

### Gallery Hall

- Goods lift - Size 5500mm x 2550mm x 2500mm (height)
- Capacity 3000kg



# Conference Centre

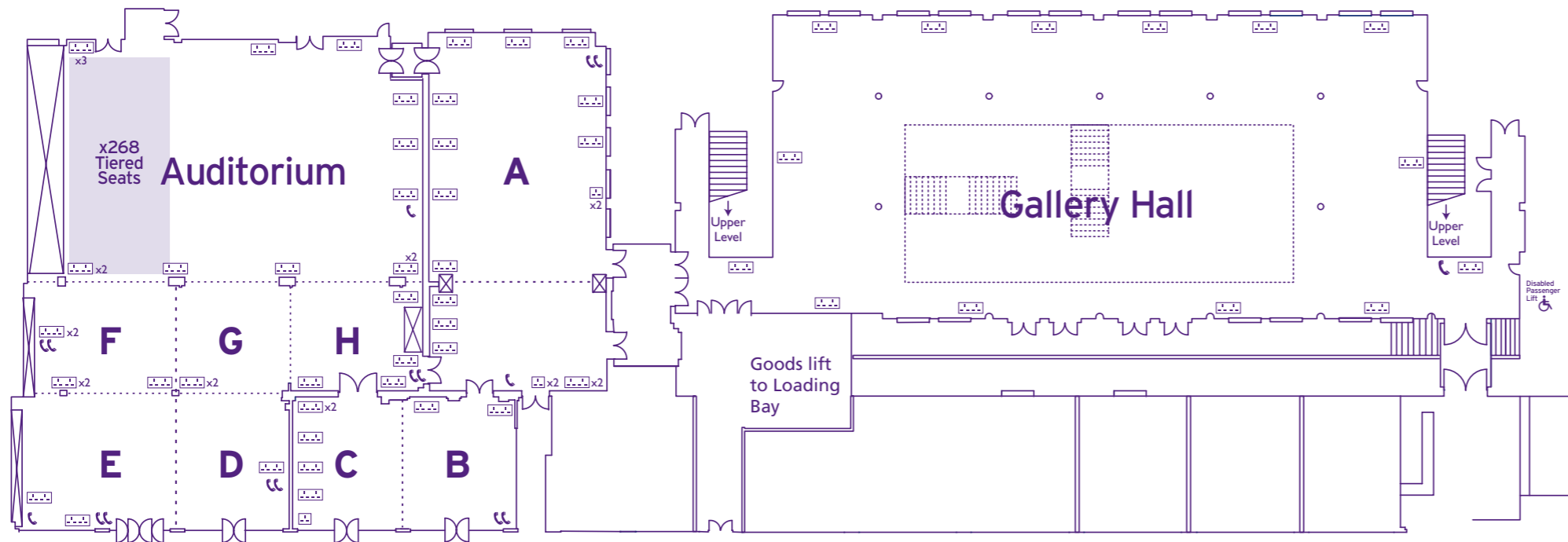
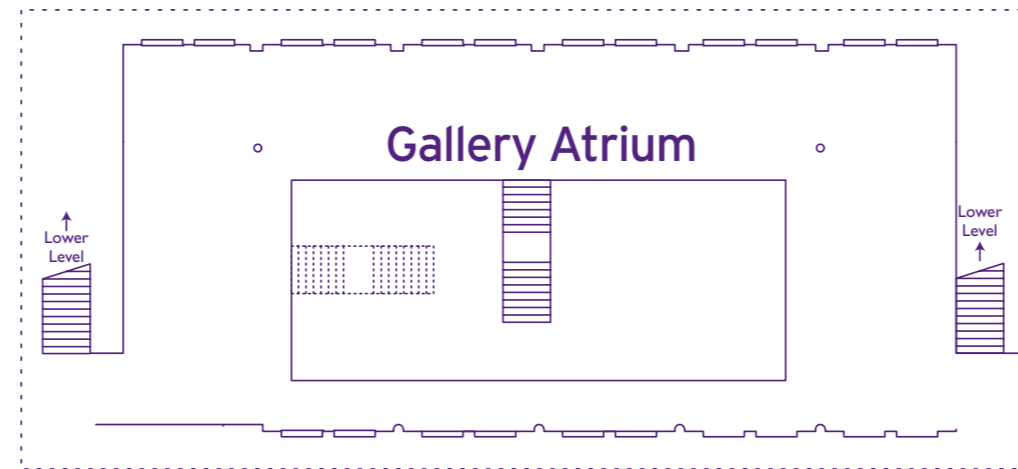

## Gallery Hall and Gallery Atrium

- Adjacent to Conference Rooms
- Registration and Catering Area or Conference Room for 650 delegates theatre/400 cabaret
- Access for goods direct to hall
- Staircase installation available at £1,500.00 + VAT
- Natural Daylight
- Full blackout facilities
- Air-conditioning
- Hall heating and general lighting
- 13 amp wall power (higher power available)
- Organiser Car Parking for event duration
- Free WiFi Open Zone (Higher bandwidth upgrade available)

## The Gallery Hall registration area is equipped with the following

- Tannoy system to the Gallery Hall
- Wired Internet Connection
- Dedicated phone line
- Photocopier
- Power sockets
- Purpose built cloakroom facilities
- Digital signage screens

## Auditorium

- Fully DDA compliant (step free access across one level)
- Conference Room for up to 500 theatre/220 cabaret
- Tiered seating for up to 268 delegates
- Air-conditioning
- Hall heating and general lighting
- 13 amp wall power (higher power available)
- Free WiFi Open Zone (Higher bandwidth upgrade available)

## Rooms A – H

- Capacity from 50 – 250 delegates
- Natural Daylight
- Full blackout facilities
- Air-conditioning
- Hall heating and general lighting
- 13 amp wall power (higher power available)
- Free WiFi Open Zone (Higher bandwidth upgrade available)

## Notes:

.....

.....

.....

.....

.....

## Capacity

	Theatre Capacity	Cabaret & Classroom Capacity	Length (M)	Width (M)	Height (M)
Mezzanine	2500	1000	70.37	30.70	16.5
Gallery Hall	650	450	42.69	19.70	6.85
Gallery Atrium	-	-	42.69	19.45	2.75
Auditorium	500	225	23.58	16.47	3.0
Room A	220	110	11.47	23.18	2.8
Room B	60	30	7.34	8.60	3.1
Room C	60	30	7.27	8.60	3.1
Room D	60	30	7.14	8.00	3.1
Room E	80	40	9.70	8.00	3.1
Room F	60	30	8.90	7.21	3.1
Room E & F	120	70	15.21	8.90	3.1
Room G	60	25	7.21	7.14	3.1

