

# CONFERENCE CENTRE

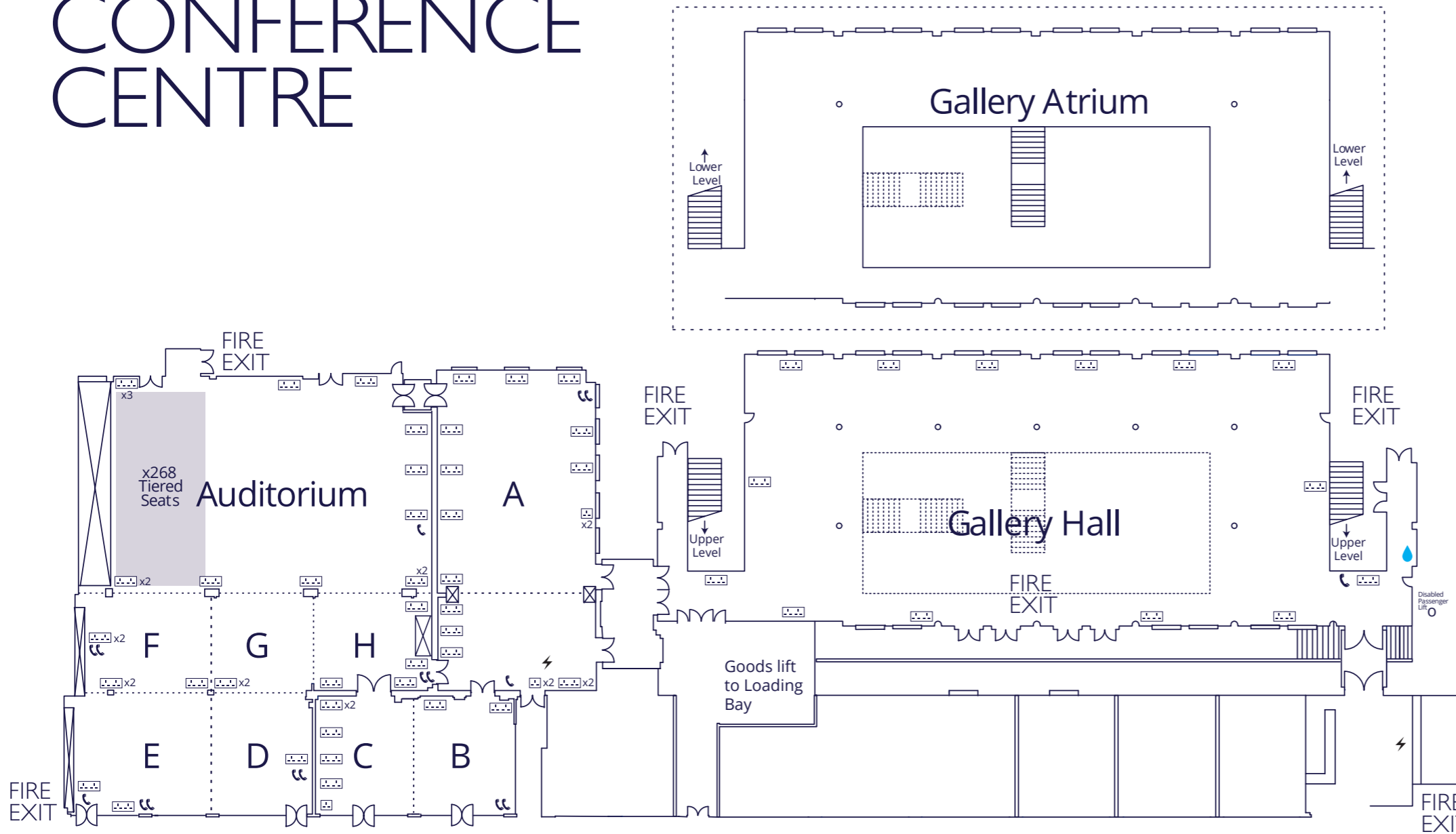

## Gallery Hall and Gallery Atrium

- Adjacent to Conference Rooms
- Registration and Catering Area or Conference Room for 650 delegates theatre/400 cabaret
- Access for goods direct to hall
- Staircase installation available at £1,500.00 + VAT
- Natural Daylight
- Full blackout facilities
- Air-conditioning
- Hall heating and general lighting
- 13 amp wall power (higher power available)
- Organiser Car Parking for event duration
- Free WiFi Open Zone (Higher bandwidth upgrade available)
- 💧 Water refill stations
- ⚡ Charging stations

## Gallery Hall registration Desk

- Tannoy system to the Gallery Hall
- Wired Internet Connection
- Dedicated phone line
- Photocopier
- Power sockets
- Purpose built cloakroom facilities
- Digital signage screens

## Auditorium

- Fully DDA compliant (step free access across one level)
- Conference Room for up to 500 theatre/220 cabaret
- Tiered seating for up to 268 delegates
- Air-conditioning
- Hall heating and general lighting
- 13 amp wall power (higher power available)
- Free WiFi Open Zone (Higher bandwidth upgrade available)

## Capacity

	Theatre Capacity	Cabaret Capacity	Classroom Capacity	Length (M)	Width (M)	Height (M)
Mezzanine	1500	900	672	70.37	30.70	16.5
Ground	-	-	-	15.49	32	-
Gallery Bays	-	-	-	7.02	4.67	-
Gallery Hall	650-700	350	298	42.7	19.75	2.8/6
Gallery Hall Atrium	-	-	-	42.7	19.75	2.8
Auditorium	500	224	144	23.5	16.66	2.8
Room A	190/250	110/144	78/102	11.45	23.02	2.8
Room B	60	32	24	7.30	8.65	2.8
Room C	60	32	24	7.40	8.65	2.8
Room D	50	32	20	7.11	7.96	2.8
Room E	80	40	40	10.81	7.96	2.8
Room F	60	32	30	10.13	7.20	2.8
Room G	35-40	24	16	7.16	7.20	2.8
Room H	35-40	24	12	10.13	7.20	2.8
Executive Centre	100	56	40	12.60	10.75	2.8

\*Please note room capacities are dependent on stage designs and sizes.

## Rooms A – H

- Capacity from 50 – 250 delegates
- Natural Daylight
- Full blackout facilities
- Air-conditioning
- Hall heating and general lighting
- 13 amp wall power (higher power available)
- Free WiFi Open Zone (Higher bandwidth upgrade available)

## Notes:

---

---

---

---

---

---

---

---

---

---

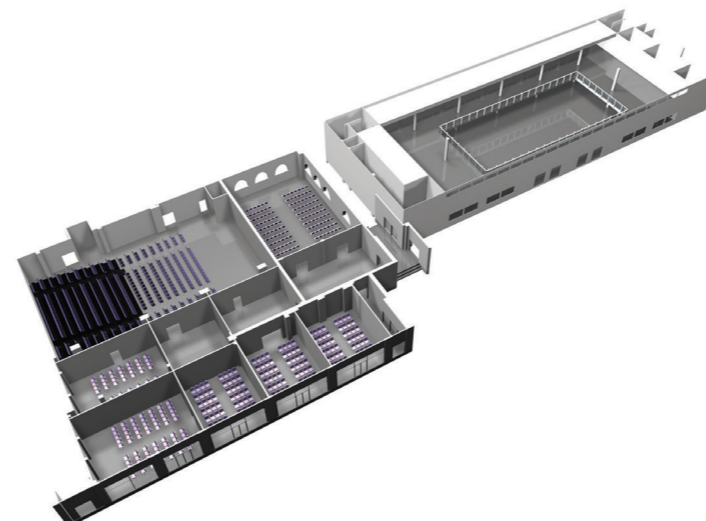

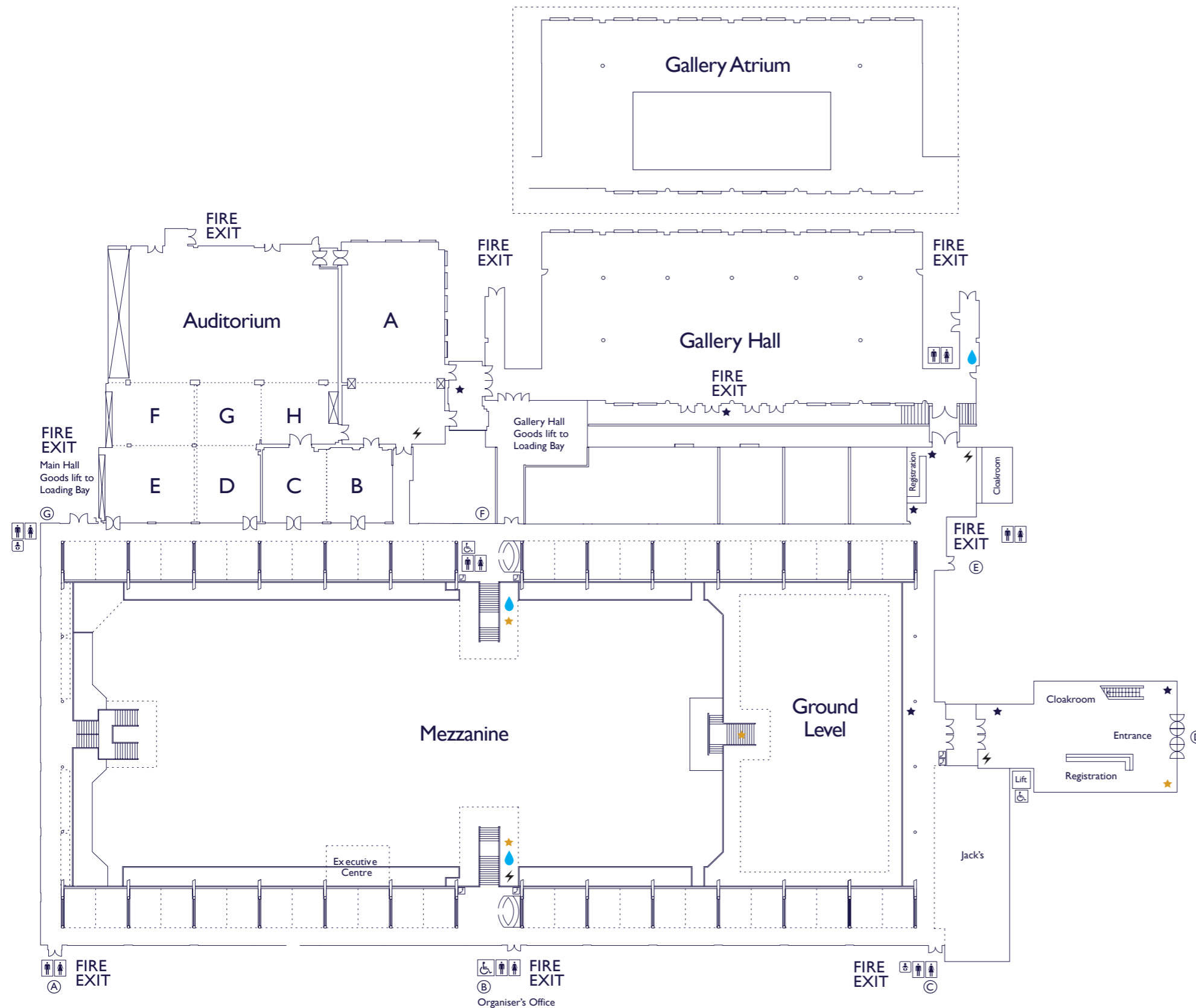

### Dimensions

	Gross Space	Net Space	Length (M)	Width (M)	Height (M)
Mezzanine	2088m <sup>2</sup>	1338 m <sup>2</sup>	70.37	30.70	16.5
Ground Level	471.5m <sup>2</sup>	352.5m <sup>2</sup>	15.49	32.0	-
Gallery Bays	1468m <sup>2</sup>	1010m <sup>2</sup>	7.02	4.67	3.0
Gallery Hall	837m <sup>2</sup>	507m <sup>2</sup>	42.7	19.75	6.85
Gallery Atrium	558m <sup>2</sup>	363m <sup>2</sup>	42.69	19.75	2.75
Conference Centre	1140m <sup>2</sup>	840m <sup>2</sup>			
<b>Total</b>	<b>6565.5m<sup>2</sup></b>	<b>4430.5m<sup>2</sup></b>			

### Notes:

.....

.....

.....

.....

.....

.....

### Mezzanine and Ground

- Fully DDA Compliant
- Fully carpeted exhibition and conference halls
- In house floor plan design service
- Manned service desk during build up and breakdown
- Access for goods direct to hall
- Hall heating and general lighting
- Secure exhibitor storage area available throughout tenancy
- Complimentary Cleaning Services to venue areas
- Digital Directional Signage
- Organiser Car Parking for event duration
- Free WiFi Open Zone (Higher bandwidth upgrade available)
- 💧 Water refill stations
- ⚡ Charging stations

### Registration Desk in the foyer

- Wired Internet Connection
- Dedicated phone line
- Power sockets
- Purpose built cloakroom facilities
- Digital signage screens

### Organiser's Office space

- Reception Area
- Private Office
- Personal Kitchen
- Photocopier
- Phones
- Fax Machine
- Internet/Phone Lines
- Sky Television
- Tannoy to main hall for announcements

### Digital Signage Locations

- Graphics to be provided by organiser (1080W x 1920L)
- Acceptable formats: VIDEO (MPEG, AVI, Divx, Xvid, VOB), AUDIO (MP3, WMA), JPEG.
- For PowerPoint templates contact your Project Manager
- All graphics to be provided no later than 5 working days prior to your event for approval by your Project Manager.

- ★ These screens are for Mezzanine events
- ★ These screens are for Gallery Hall and Atrium events

### Ⓐ Stairwells

There are 2 goods lifts in the Loading Bay for the delivery of stand materials and exhibits.

#### Main Hall

- Goods Lift - Size 4000mm x 1900mm x 1900m (height)
- Capacity 3000kg
- Gallery Hall**
- Goods lift - Size 5500mm x 2550mm x 2500mm (height)
- Capacity 3000kg